

Tolerances for ducts

Material thickness/gauge

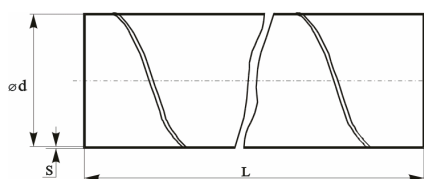

ød nom, mm	ød tolerance, mm min-max	Material thickness (S) nom, mm
100	100.0-100.5	0,5
125	125.0-125.5	0,5
160	160.0-160.6	0,5
200	200.0-200.7	0,5
250	250.0-250.8	0,5
315	315.0-315.9	0,6
400	400.0-401.0	0,6
500	500.0-501.1	0,6
600	630.0-631.2	0,6
800	800.0-801.6	0,7
1000	1000.0-1002.0	0,9
1250	1250.0-1252.5	0,9

Length tolerances	
ød nom, mm	Tolerances mm
0 - 250	±10
251 - 400	±15
401 - 600	±20
600 - 1250	±25

Tolerances for fittings

Angle tolerances

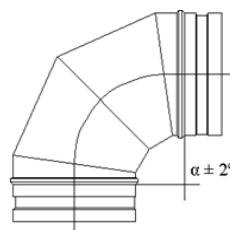
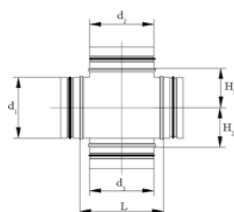
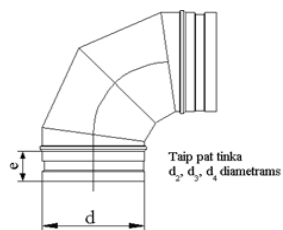

ød nom, mm	Ød tolerance, mm min-max	Material thickness (S) nom, mm
100	98.8 - 99.3	0,55
125	123.8 - 124.3	0,55
160	158.7 - 159.3	0,55
200	198.6 - 199.3	0,55
250	248.5 - 249.3	0,55
315	313.4 - 314.3	0,55
400	398.3 - 399.3	0,7
500	498.2 - 499.3	0,7
630	628.1 - 629.3	0,7
800	798.0 - 799.3	1,0
1000	997.9 - 999.3	1,0
1250	1247.8 - 1249.3	1,0
	e (mm)	Tolerance (mm)
80 - 224	36	+0 -5
250 - 355	55	+0 -5
400 - 630	75	+0 -10
710 - 900	100	+0 -10
1000 - 1250	115	+0 -15

Ducts and fittings are made from galvanized steel

